

SITE PLAN - INDUSTRIAL FACILITY

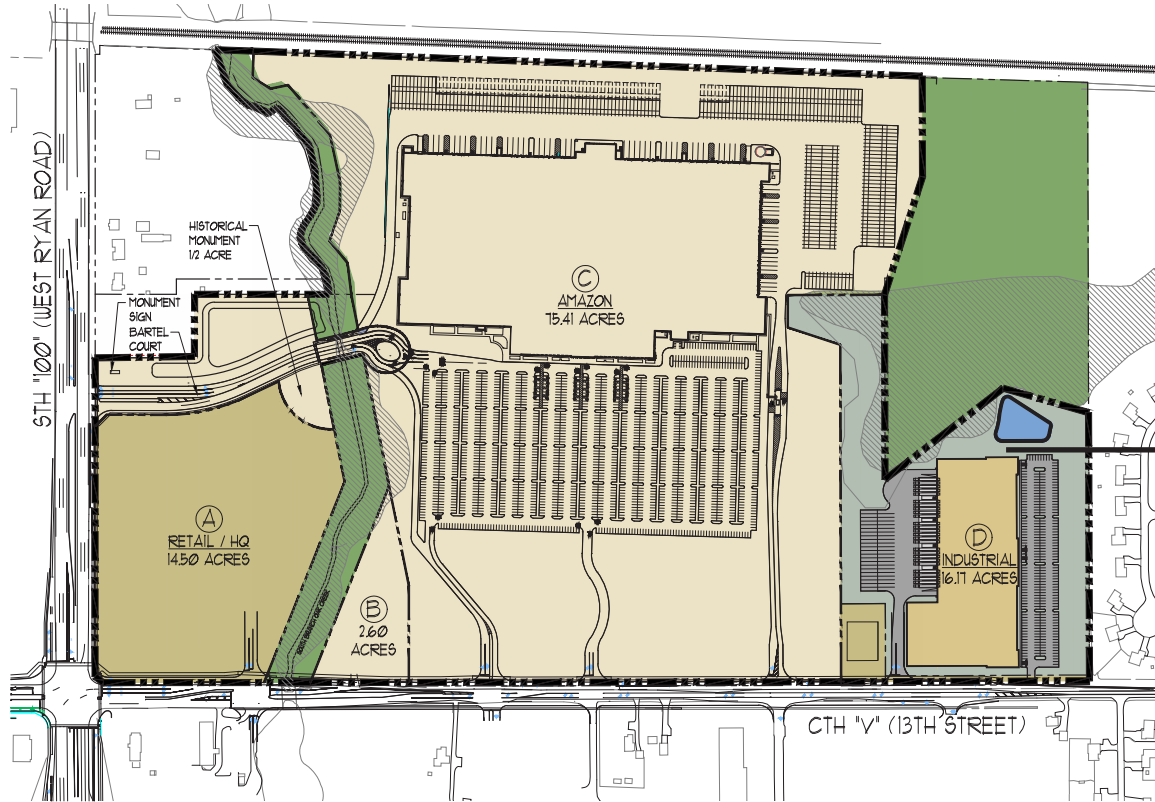

PARCELS:

- A RETAIL/HQ
14.50 ACRES
- B STORMWATER RETENTION POND
2.60 ACRES
- C AMAZON
15.41 ACRES
- D INDUSTRIAL
16.11 ACRES

±199,000
SF Facility

DEVELOPED BY:

CAPSTONE QUADRANGLE

GENERAL CAPITAL

RYAN BUSINESS PARK

Overall Site Plan

© 2019 Partners in Design Architects, Inc.



1" = 300'-0"
01.25.19



Partners in Design
ARCHITECTS

262.652.2800
Kenosha, WI

847.940.0300
Riverwoods, IL

SAMPLE INDUSTRIAL BUILDING

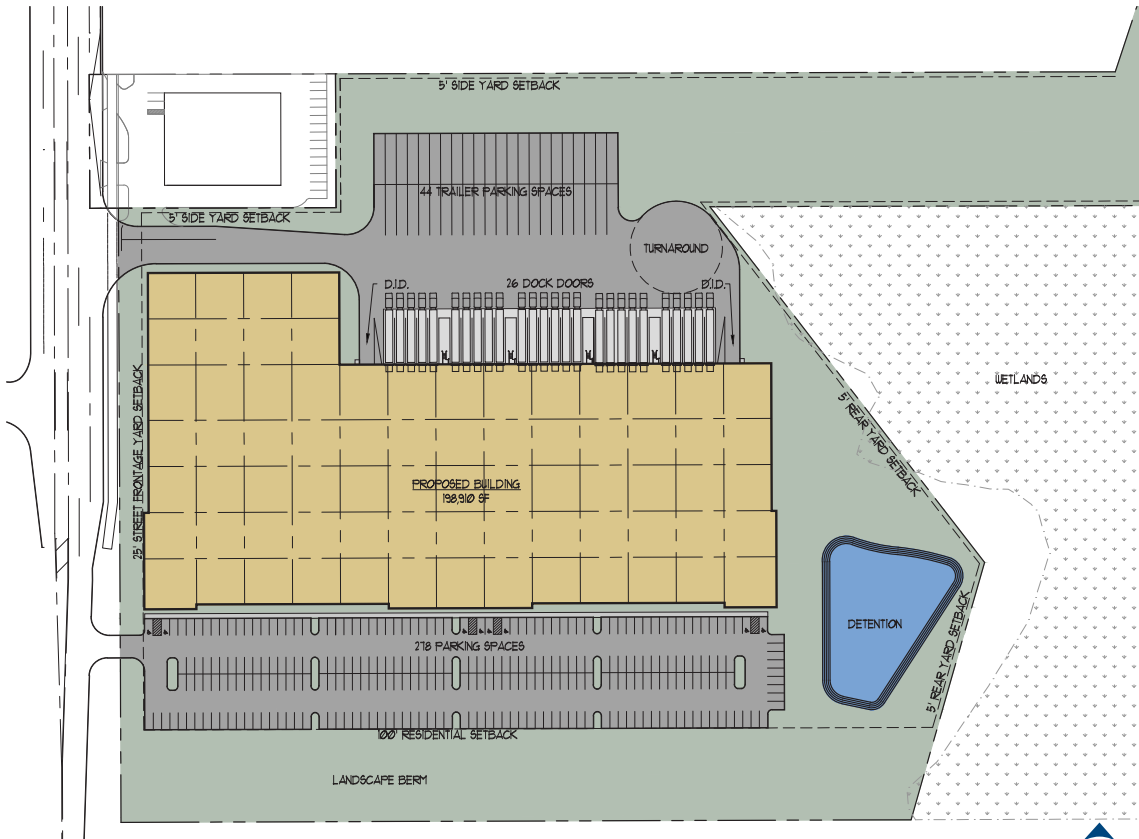

± 199,000 SF
Industrial Building
on Remaining
Industrial Site

PROPOSED DEVELOPMENT PLAN

New South Oak, Oak Creek, WI

© 2018 Partners in Design Architects, Inc.



1" = 100'-0"
01.08.19

CAPSTONE QUADRANGLE

GENERAL CAPITAL



Partners in Design
ARCHITECTS

262.652.2800
Kenosha, WI

847.940.0300
Riverwoods, IL